

KITCHEN CABINETS, EXTERIOR WALL

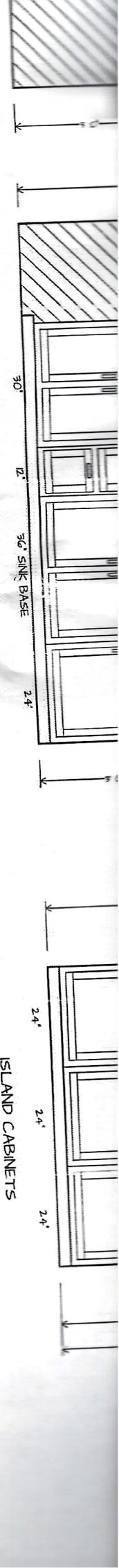

DESIGN NOTES:

1. INTERIOR BEDROOM DOORS, UTILITY / KITCHEN DOOR AND DOORS IN THE FOYER TO BE TRANSOM DOORS. ALL OTHER INTERIOR DOORS TO BE STANDARD 6'8" PINE FOUR PANEL.
2. ALL WINDOWS TO BE ANDERSEN WOODWRIGHT SERIES 400, WITH SCREENS AND SINGLE CENTER MUTTONS IN EACH PANEL. EXTERIOR COLOR TO BE WHITE.
3. CABINETS TO BE WOOD SHAKER STYLE CABINETS PAINTED WHITE.
4. TILE SHOWERS TO BE HARD TILE AS PER SELECTION. SLIDING DOORS TO BE ANDERSEN WOODWRIGHT 8' BY 6' UNITS WITH DEAD BOLTS, SCREENS AND HARDWARE AS PER SELECTION.
5. EXTERIOR ENTRY DOORS TO BE 8' WOOD DOORS AS PER SELECTION. ALL OTHER FLOORS ARE TO BE 3/4" WOOD T&G AS PER SELECTION.
6. FLOORS IN THE FOYER AND AROUND FIREPLACE ARE TO BE HARD TILE AS PER SELECTION. NO FLOOR VENTS ARE TO BE USED.
7. HVAC SYSTEM IS TO BE LOCATED IN FINISHED ATTIC AREA WITH ALL ROOMS FED FROM CEILING OR WALL VENTS. THE GENERATOR IS TO USE PROPRANE FUEL AND A 500 GALLON OR LARGER TANK. IT TO BE LOCATED ON THE PROPERTY.
8. MASONRY FIREPLACE, HEARTH AND MANTEL MAY VARY AFTER CONSULTATION WITH MASON.
9. A GENERAC WHOLE HOUSE GENERATOR, ESTIMATED AT 22KW, IS TO BE INSTALLED AS PART OF CONSTRUCTION. THE GENERATOR IS TO USE PROPRANE FUEL AND A 500 GALLON OR LARGER TANK. IT TO BE LOCATED ON THE PROPERTY.
10. POWER AND CABLE LINES AND FIXTURES ARE TO BE PROVIDED TO BOTH SIDES OF THE FIREPLACE UNIT ABOVE THE MANTEL.
11. A CAST IRON FIREPLACE CRANE IS TO BE PROVIDED FOR THE KITCHEN FIREPLACE AND INSTALLED BY THE MASON.

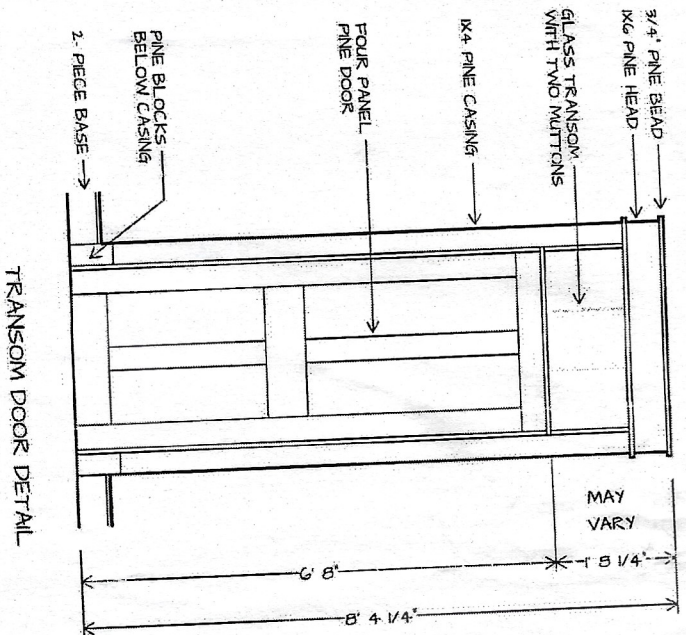

TRANSOM DOOR DETAIL

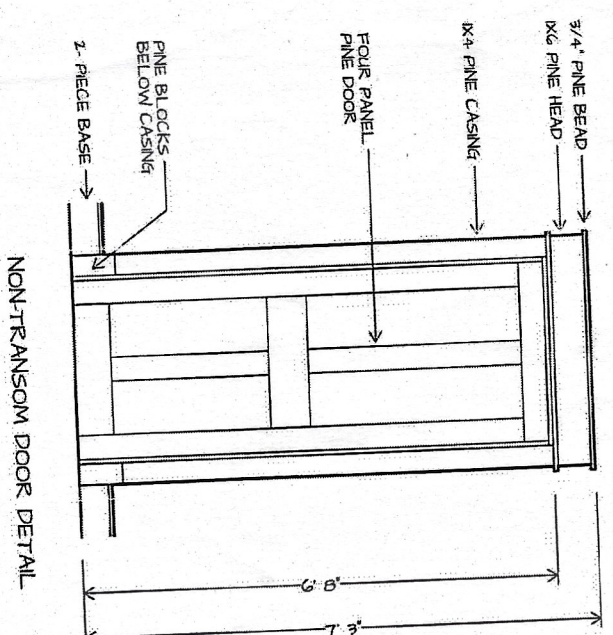

NON-TRANSOM DOOR DETAIL

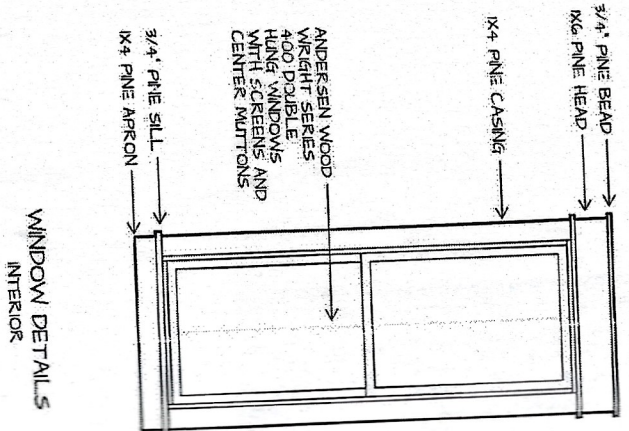

WINDOW DETAILS INTERIOR

DESIGN NOTES & DETAILS 3/8" = 1' 0"

REVISED 12/21/2020

